



SuiteCRM Record Restore Manager

Installation Guide

Pre-requisites

Please follow the below steps before installing the Record Restore Manager.

1. Log in as an Administrator.
2. Verify the CRM version should be compatible with Record Restore Manager.
3. install the Outright Record Restore Manager.

Installation Guide

1. Go to the Administration page.
2. Click on “**Module Loader**” to install the package.

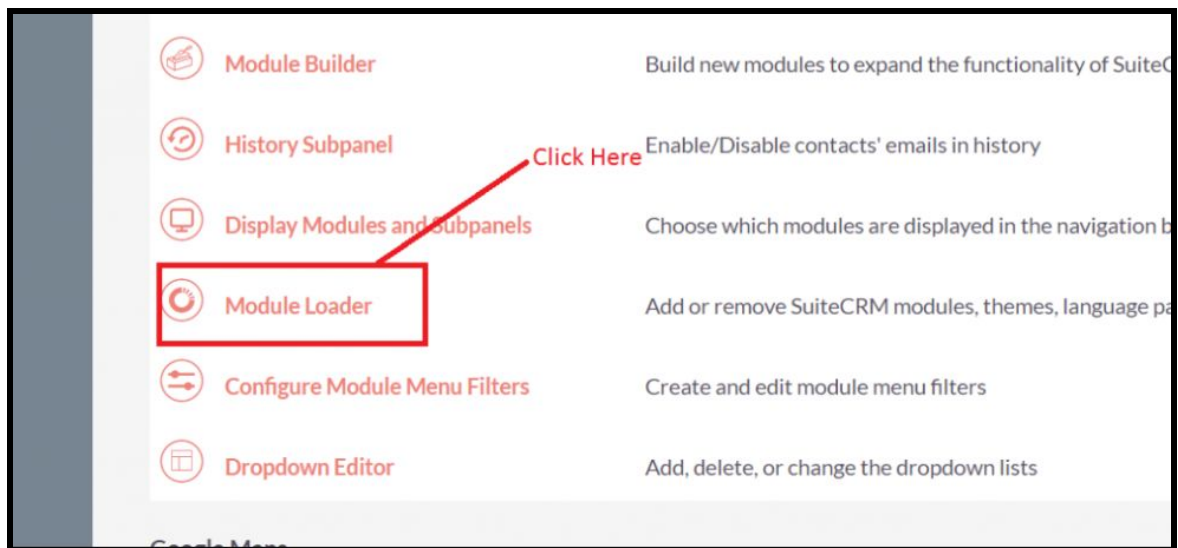

3. Click on the “**Choose File**” button and select the Record Restore manager.zip.

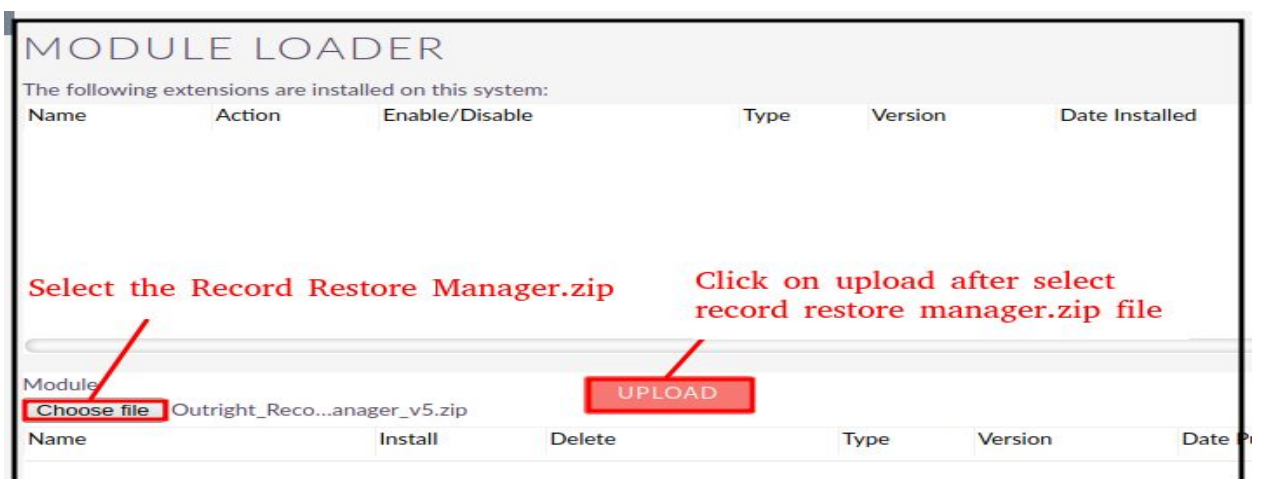

4. Click on "Upload" to upload the file in CRM and then click on the Install button.

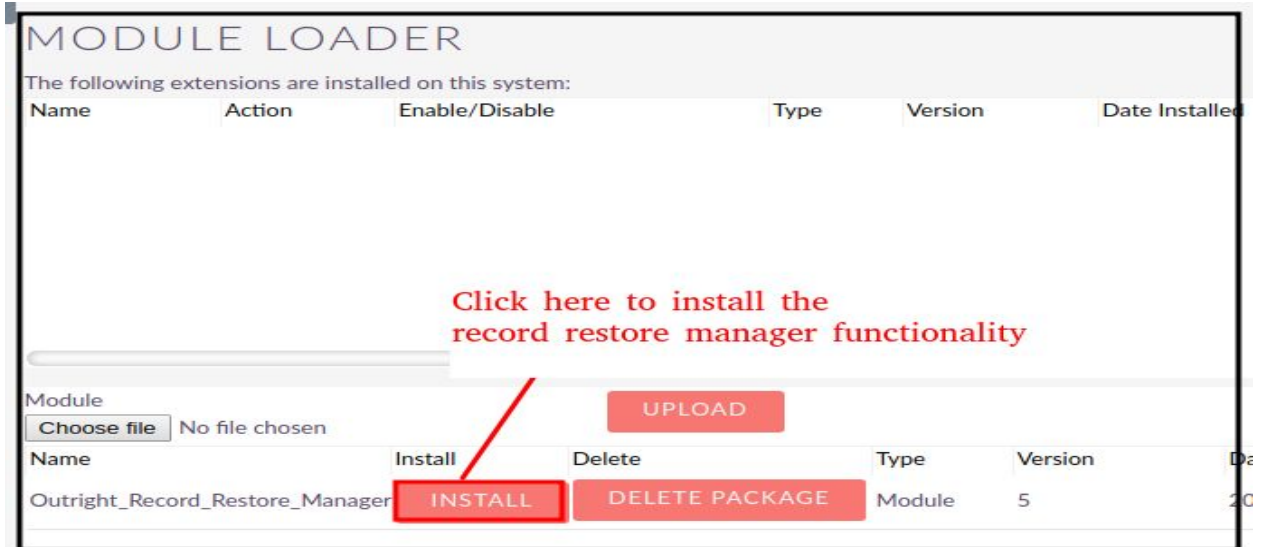

5. Again go to the Administration page and click on repair.

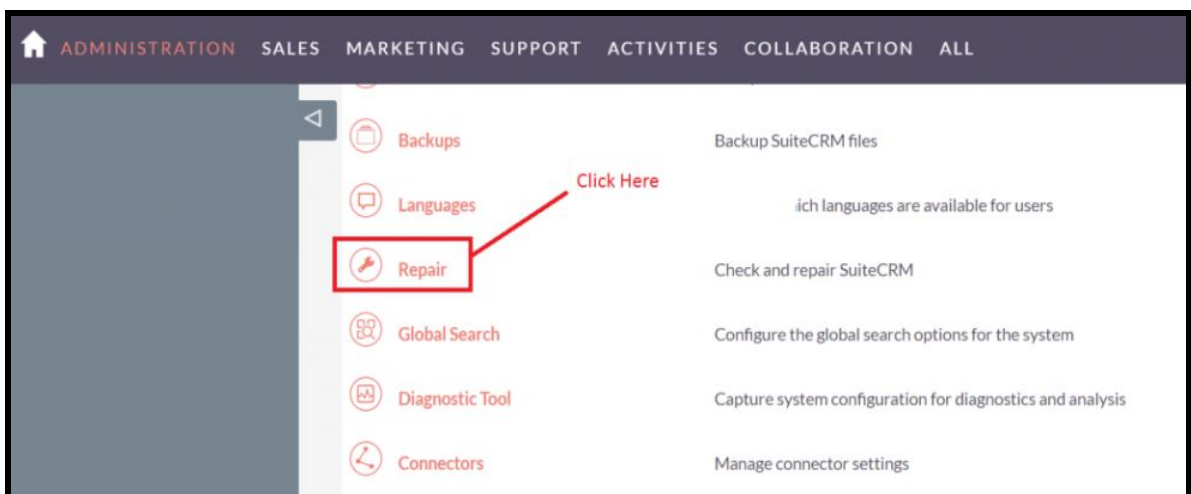



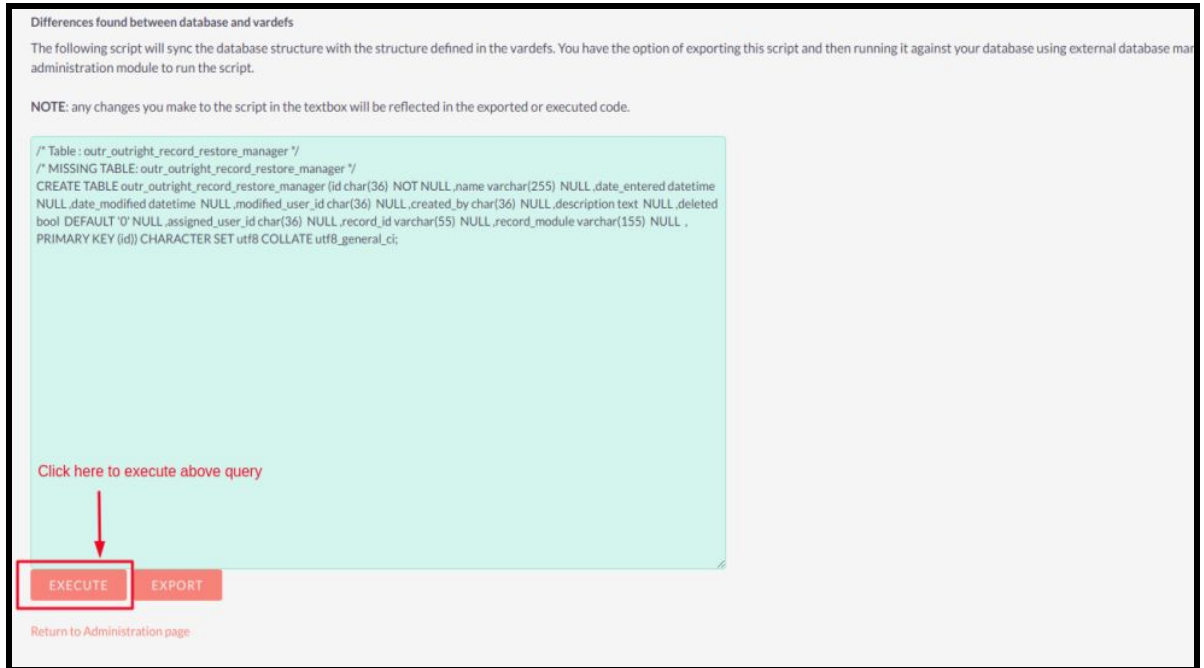

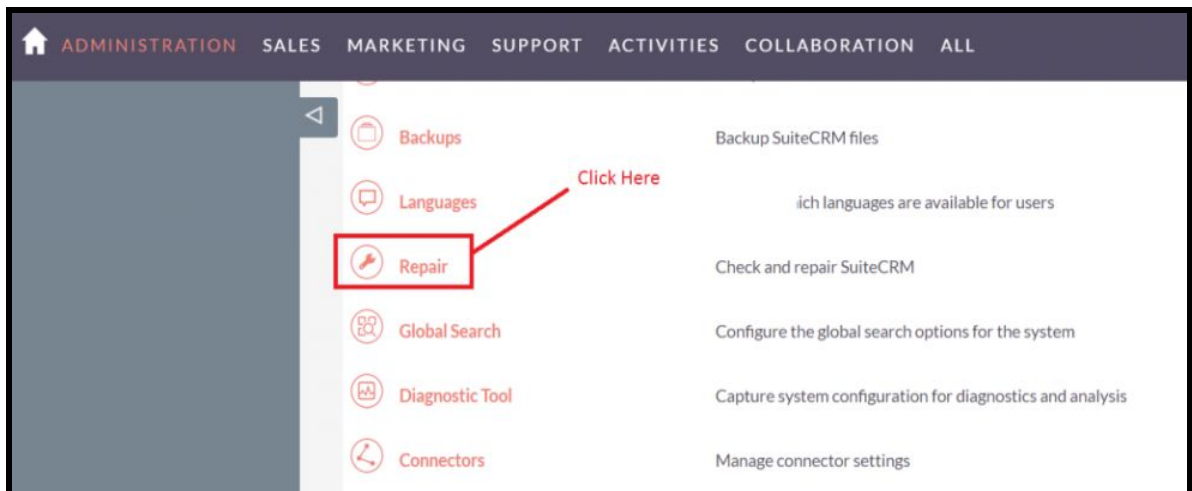

- 6. Click on "Quick Repair and Rebuild" and click on the execute button.



- 7. Again go to the Administration page and click on repair.



8. Click on "Repair Roles".

	Repair JS Files	Compresses Existing JS files - includes any changes made, but does not overwrite
	Repair Non-Lowercase Fields	Repair mixed-case custom table(s) and metadata file(s) to fix issues where code exp
	Repair Roles 	Repairs Roles by adding all new modules that support Access Controls, and by add
	Repair Inbound Email Accounts	Repairs Inbound Email accounts and encrypts account passwords
	Sync Inbound Email Accounts	Sync Inbound Email Accounts and Emails

NOTE - : After installing each plugin, It is mandatory to repair and execute.