



SuiteCRM Direct Delete From List View

Installation/Configuration Guide

Pre-requisites

Please follow the below steps before installing the Direct Delete from ListView Row.

1. Log in as an Administrator.
2. Verify the CRM version should be compatible with Direct Delete from ListView Row.

Installation Guide

1. Go to the Administration page.
2. Click on “**Module Loader**” to install the package.

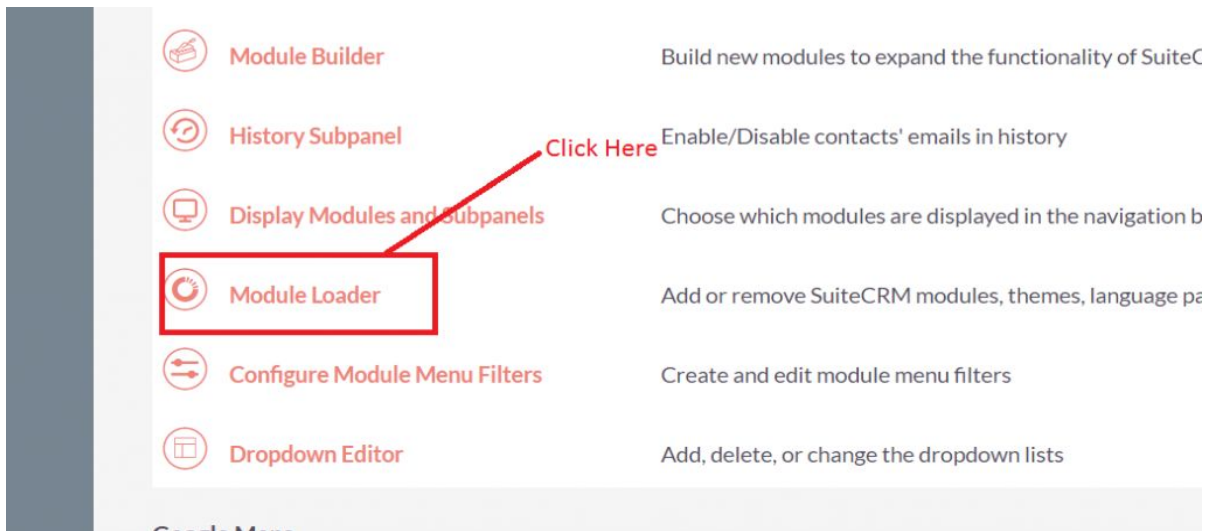

3. Click on “**Choose File**” button and select the Delete Manager.zip



4. Click on "**Upload**" to upload the file in CRM and then click on the Install button.

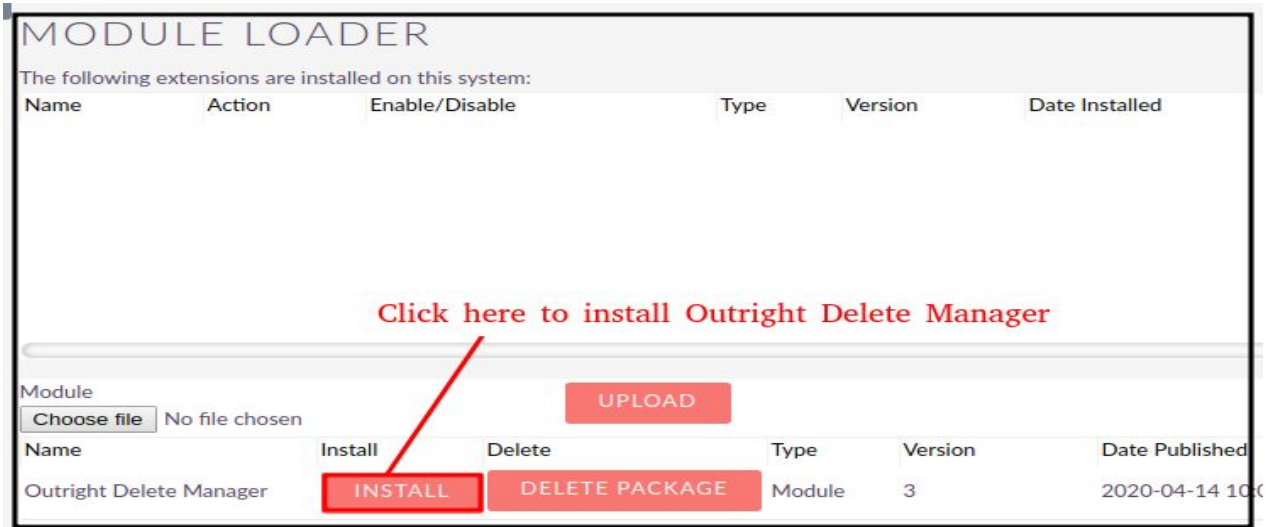

5. Again go to the Administration page and click on repair.

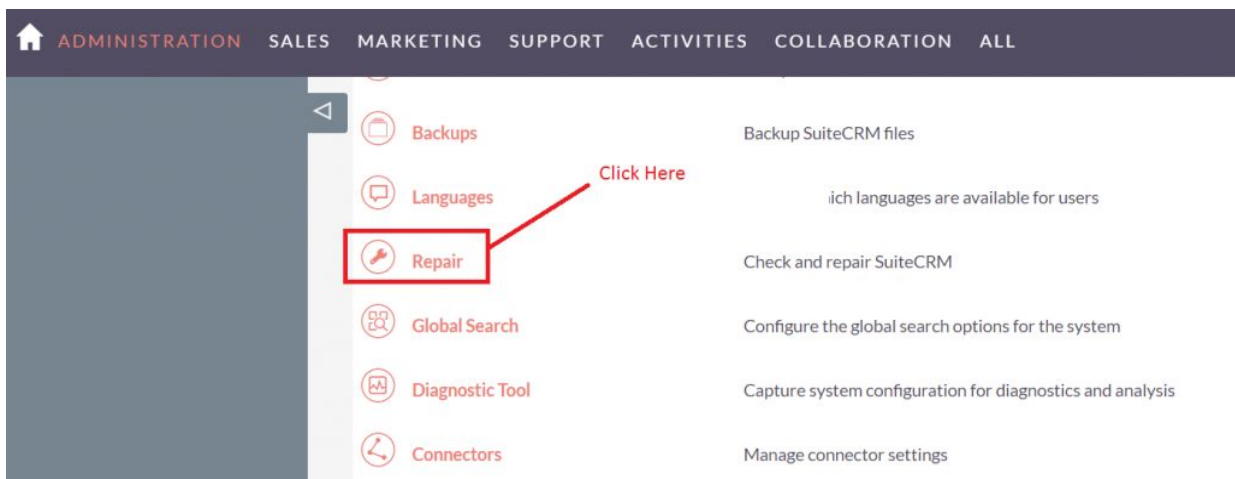

6. Click on "**Quick Repair and Rebuild**" and click on execute button.

NOTE: After installing each plugin, It is mandatory to repair and execute.

Configuration Guide

1. Go to the Administration page.
2. Click on the Delete Manager to configure the modules for delete functionality.
3. Enter the name of the settings and select those modules, which you want to enable the delete button functionality.

SUPPORT ACTIVITIES COLLABORATION ALL CREATE Admin

Note: To send record assignment notifications, an SMTP server must be configured in [Email Settings](#).

CREATE

SAVE CANCEL

BASIC

Name:* Outright Delete Manager Module List:*

Enable:*

SAVE CANCEL

Select the Modules from the dropdown list

- Leads
- Contacts
- Accounts
- Opportunities
- Emails
- EmailTemplate

4. Select the checkbox "Enable" to enable the delete button functionality.

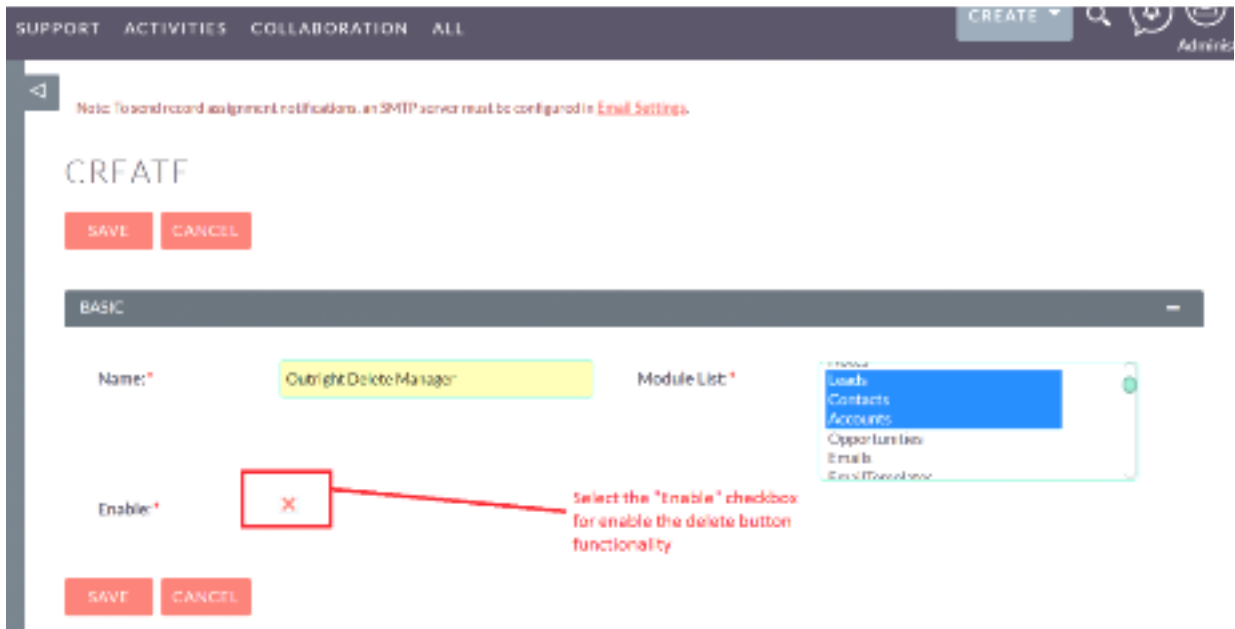

NOTE: After installing each plugin, It is mandatory to repair and execute.