



# **SuiteCRM Global Search**

## **Installation Guide**

## Pre-requisites

Please follow the below steps before installing the Global Search.

1. Log in as an Administrator.
2. Verify the CRM version should be compatible with Global Search.
3. CRM should have the Outright utils file, if not then install the Outright Utils package first then install Global Search.

# Installation Guide

1. Go to the Administration page.
2. Click on “**Module Loader**” to install the package.

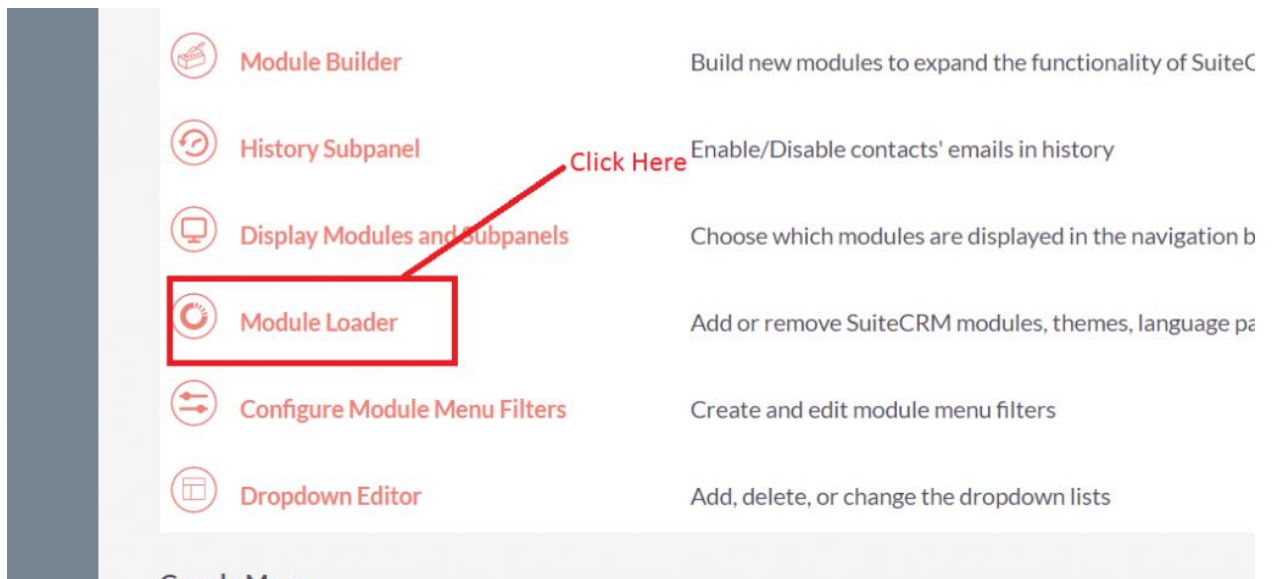

3. Click on “**Choose File**” button and select the Global Search.zip

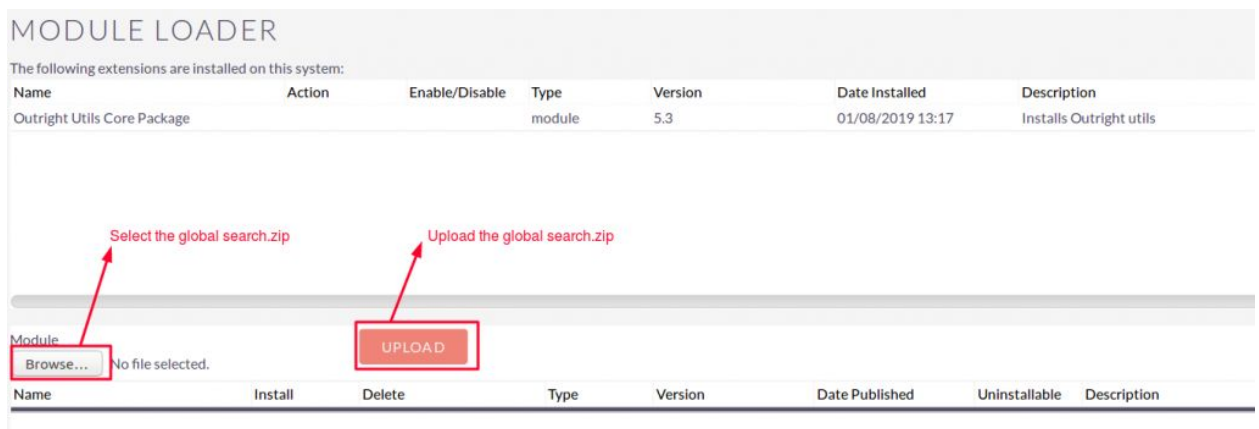

4. Click on **"Upload"** to upload the file in CRM and then click on the Install button.

MODULE LOADER

The following extensions are installed on this system:

Name	Action	Enable/Disable	Type	Version	Date Installed	Description
Outright Utils Core Package			module	5.3	01/08/2019 13:17	Installs Outright utils

CLICK HERE TO INSTALL GLOBAL SEARCH

Module  
Browse... No file selected. **UPLOAD**

Name	Install	Delete	Type	Version	Date Published	Uninstallable	Description
Outright_Global Search	<b>INSTALL</b>	<b>DELETE PACKAGE</b>	Module	3.0	2019-01-07 12:54:36	Yes	Outright Global Search Manager

5. Again go to the Administration page and click on repair.

ADMINISTRATION SALES MARKETING SUPPORT ACTIVITIES COLLABORATION ALL

Backups Backup SuiteCRM files

Languages Which languages are available for users

**Repair** Click Here Check and repair SuiteCRM

Global Search Configure the global search options for the system

Dagnostic Tool Capture system configuration for diagnostics and analysis

Connectors Manage connector settings

6. Click on **"Quick Repair and Rebuild"** and click on the execute button.



**NOTE: After installing each plugin, It is mandatory to repair and execute.**