



DocuSign

Prerequisites

Please follow the below steps before installing the DocuSign connector.

1. Log in as an Administrator.
2. Verify the CRM version should be compatible with DocuSign connector.
3. CRM should have the Outright utils file, if not then install the OutrightUtils package first then install the DocuSign connector.

Installation Guide

1. Go to the Administration page.
2. Click on “**Module Loader**” to install the package.

NOTE: after installing each plugin, It is mandatory to repair and execute.

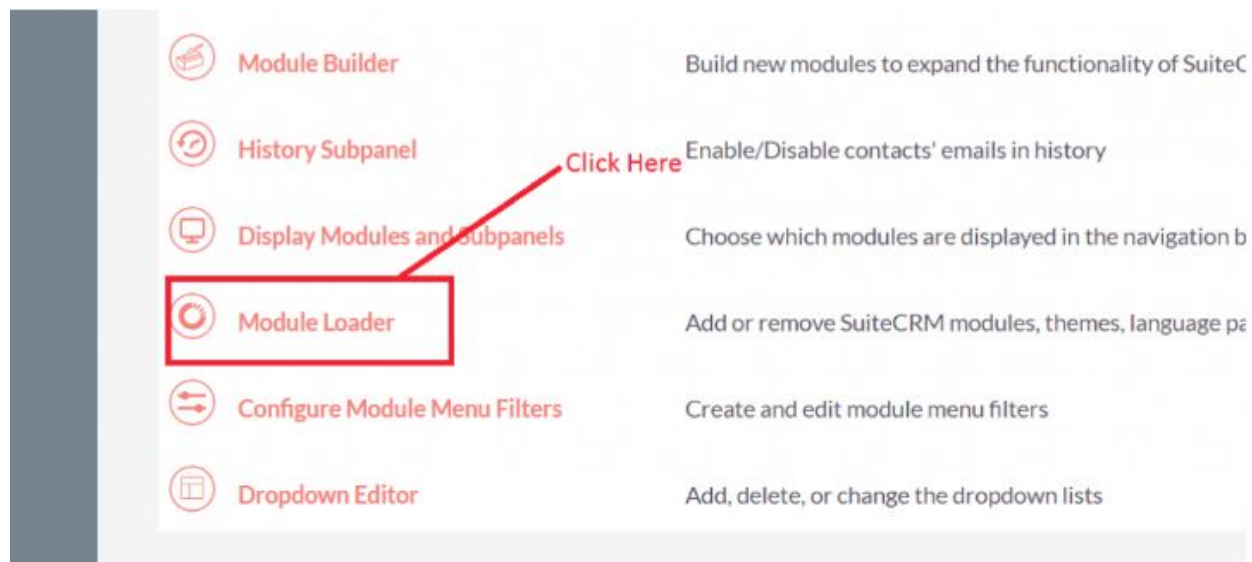

3. Click on “**Choose File**” button and select the Theme Style Builder.zip.

DocuSign

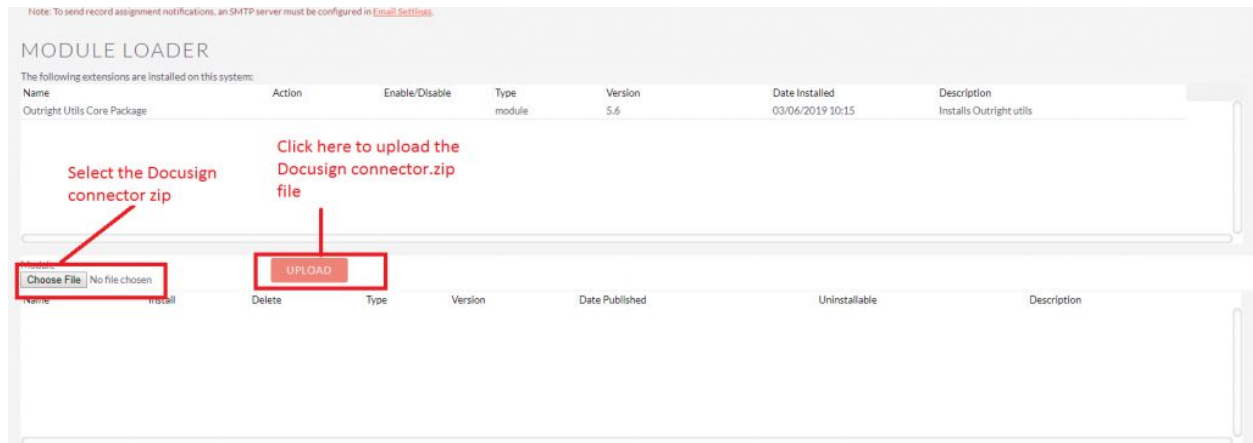

4. Click on “**Upload**” to upload the file in CRM and then click on the Install button.

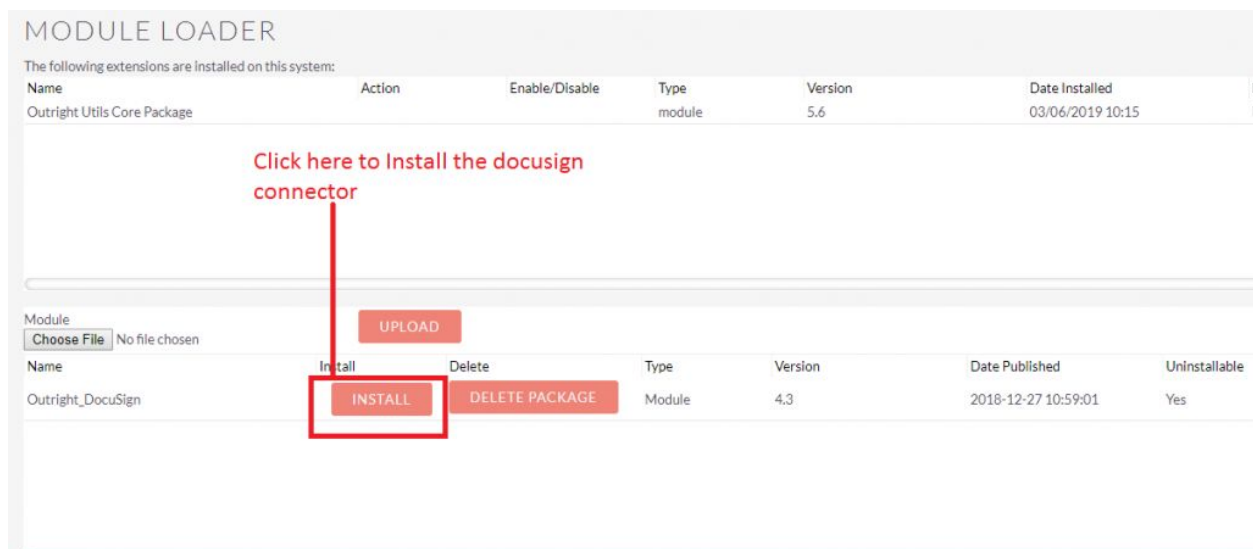

5. Again go to the Administration page and click on repair.

Docusign

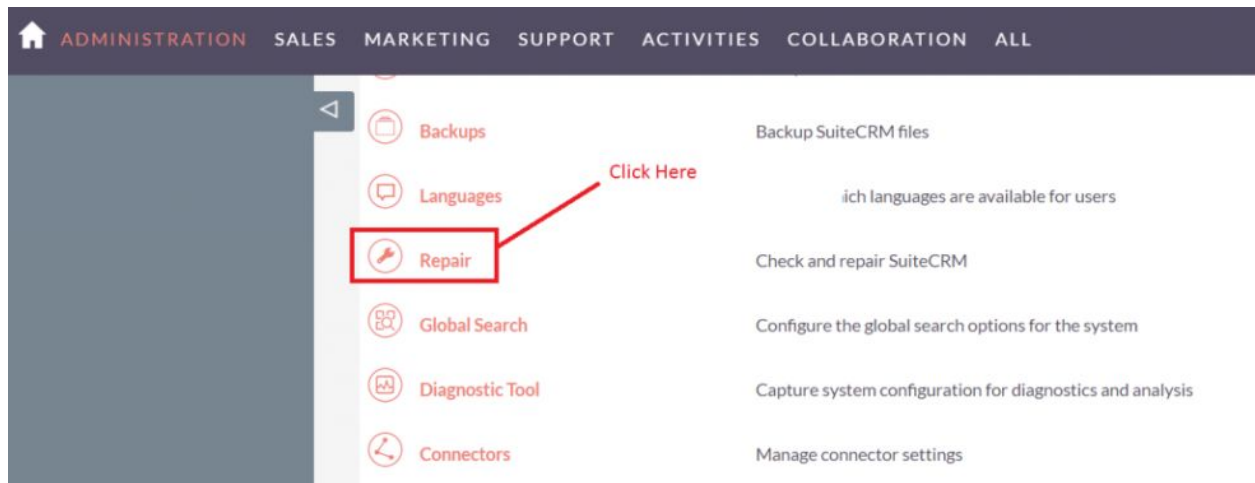

6. Click on "**Quick Repair and Rebuild**" and click on execute button.

DocuSign

Audit table for or_docu_docs already exists. skipping...

Audit table for outr_docu_sign_status already exists. skipping...

Done

Differences found between database and vardefs

The following script will sync the database structure with the structure defined in the vardefs. You have the option of exporting this script and then running it against your database using the module to run the script.

NOTE: any changes you make to the script in the textbox will be reflected in the exported or executed code.

```
/* Table: accounts_docu_sign_template_1_c */
/* MISSING TABLE: accounts_docu_sign_template_1_c */
CREATE TABLE accounts_docu_sign_template_1_c (id varchar(36) NOT NULL ,date_modified datetime NULL ,deleted bool DEFAULT '0' NULL ,accounts_docu_sign_template_1accounts_ida varchar(36) NULL ,accounts_docu_sign_template_1docu_sign_template_idb varchar(36) NULL , PRIMARY KEY (id), KEY accounts_docu_sign_template_1_alt (accounts_docu_sign_template_1accounts_ida, accounts_docu_sign_template_1docu_sign_template_idb)) CHARACTER SET utf8 COLLATE utf8_general_ci;
/* Table: accounts_or_docu_docs_1_c */
/* MISSING TABLE: accounts_or_docu_docs_1_c */
CREATE TABLE accounts_or_docu_docs_1_c (id varchar(36) NOT NULL ,date_modified datetime NULL ,deleted bool DEFAULT '0' NULL ,accounts_or_docu_docs_1accounts_ida varchar(36) NULL ,accounts_or_docu_docs_1or_docu_docs_idb varchar(36) NULL , PRIMARY KEY (id), KEY accounts_or_docu_docs_1_ida1 (accounts_or_docu_docs_1accounts_ida), KEY accounts_or_docu_docs_1_alt (accounts_or_docu_docs_1or_docu_docs_idb)) CHARACTER SET utf8 COLLATE utf8_general_ci;
/* Table: contacts_docu_sign_template_1_c */
/* MISSING TABLE: contacts_docu_sign_template_1_c */
CREATE TABLE contacts_docu_sign_template_1_c (id varchar(36) NOT NULL ,date_modified datetime NULL ,deleted bool DEFAULT '0' NULL ,contacts_docu_sign_template_1contacts_ida varchar(36) NULL ,contacts_docu_sign_template_1alt varchar(36) NULL , PRIMARY KEY (id), KEY contacts_docu_sign_template_1_alt (contacts_docu_sign_template_1contacts_ida, contacts_docu_sign_template_1alt)) CHARACTER SET utf8 COLLATE utf8_general_ci;
/* Table: contacts_or_docu_docs_1_c */
/* MISSING TABLE: contacts_or_docu_docs_1_c */
CREATE TABLE contacts_or_docu_docs_1_c (id varchar(36) NOT NULL ,date_modified datetime NULL ,deleted bool DEFAULT '0' NULL ,contacts_or_docu_docs_1contacts_ida varchar(36) NULL ,contacts_or_docu_docs_1or_docu_docs_idb varchar(36) NULL , PRIMARY KEY (id), KEY contacts_or_docu_docs_1_ida1 (contacts_or_docu_docs_1contacts_ida), KEY contacts_or_docu_docs_1_alt (contacts_or_docu_docs_1or_docu_docs_idb)) CHARACTER SET utf8 COLLATE utf8_general_ci;
```

Click here to execute the query

EXECUTE **EXPORT**