



## Faster Global Search for SuiteCRM

### **Pre-requisites**

Please follow the below steps before installing the Global Search.

1. Log in as an Administrator.
2. Verify the CRM version should be compatible with Global Search.
3. CRM should have the Outright utils file, if not then install the Outright Utils package first then install Global Search.

## Installation Guide:-

1. Go to the Administration page.
2. Click on "**Module Loader**" to install the package.

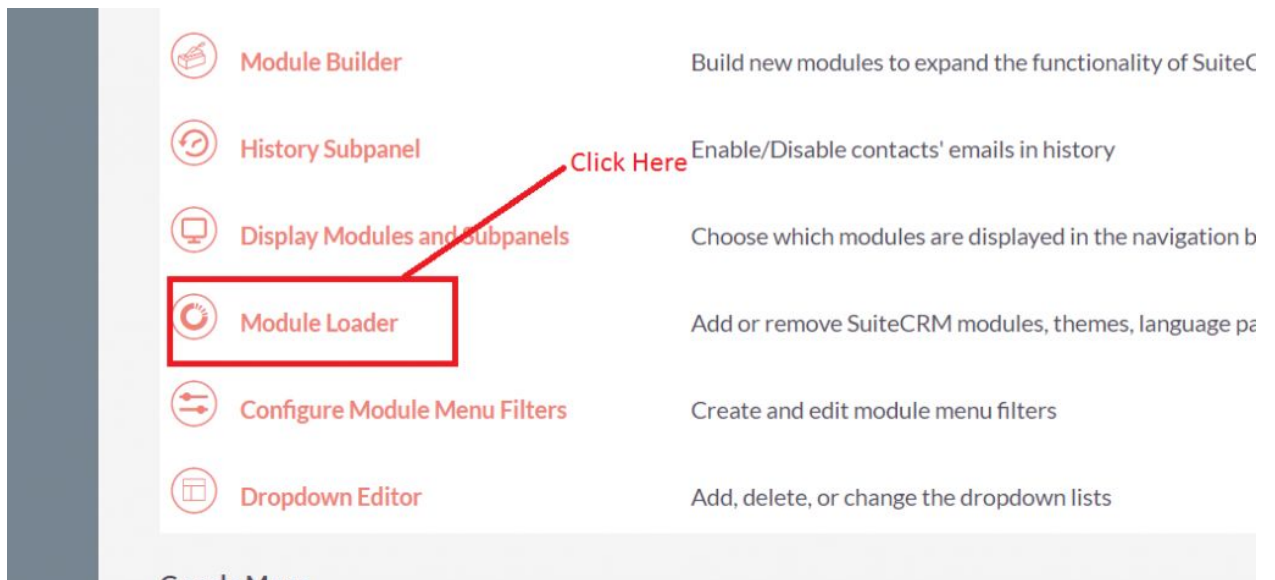

3. Click on "**Choose File**" button and select the Global Search.zip

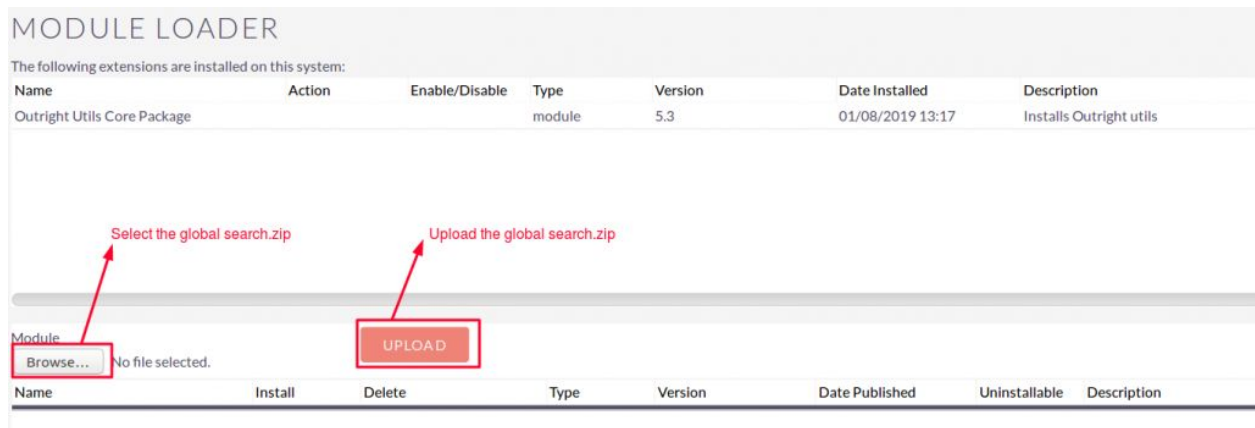

4. Click on **"Upload"** to upload the file in CRM and then click on the Install button.

MODULE LOADER

The following extensions are installed on this system:

Name	Action	Enable/Disable	Type	Version	Date Installed	Description
Outright Utils Core Package			module	5.3	01/08/2019 13:17	Installs Outright utils

Module:  No file selected.

Name	Install	Delete	Type	Version	Date Published	Uninstallable	Description
Outright_Global Search	<input type="button" value="INSTALL"/>	<input type="button" value="DELETE PACKAGE"/>	Module	3.0	2019-01-07 12:54:36	Yes	Outright Global Search Manager

CLICK HERE TO INSTALL GLOBAL SEARCH

5. Again go to the Administration page and click on repair.

ADMINISTRATION SALES MARKETING SUPPORT ACTIVITIES COLLABORATION ALL

- Backups: Backup SuiteCRM files
- Languages: Which languages are available for users
- Repair**: Check and repair SuiteCRM
- Global Search: Configure the global search options for the system
- Diagnostic Tool: Capture system configuration for diagnostics and analysis
- Connectors: Manage connector settings

Click Here

6. Click on "**Quick Repair and Rebuild**" and click on execute button.



**NOTE:** after installing each plugin, It is mandatory to repair and execute.