



Global Hide Manager

TEST4

OVERVIEW

MORE INFORMATION

ACTIONS

Type:

Annual Revenue:

Member of:

Campaign:

Industry:

Employees:

Back

Refresh

Reload

Save as...

Print...

Call...

Translate to English

View page source

Inspect

Ctrl+H

Ctrl+S

Ctrl+P

Ctrl+U

Ctrl+Shift+S

TEST4

OVERVIEW

MORE INFORMATION

OTHER

ACTIONS

Type:

Annual Revenue:

Industry:

Employees:

Elements

Styles

Scripts

Network

Performance

Console

Application

Security

Audio

class="hidden-xs active"

SuiteCRM Global Hide Manager

Pre-requisites

Please follow the below steps before installing the Global Hide Manager.

1. Log in as an Administrator.
2. Verify the CRM version should be compatible with Global Hide Manager.
3. CRM should have the Outright utils file, if not then install the Outright Utils package first then install Global Hide Manager.

Installation Guide:-

1. Go to the Administration page.
2. Click on “**Module Loader**” to install the package.

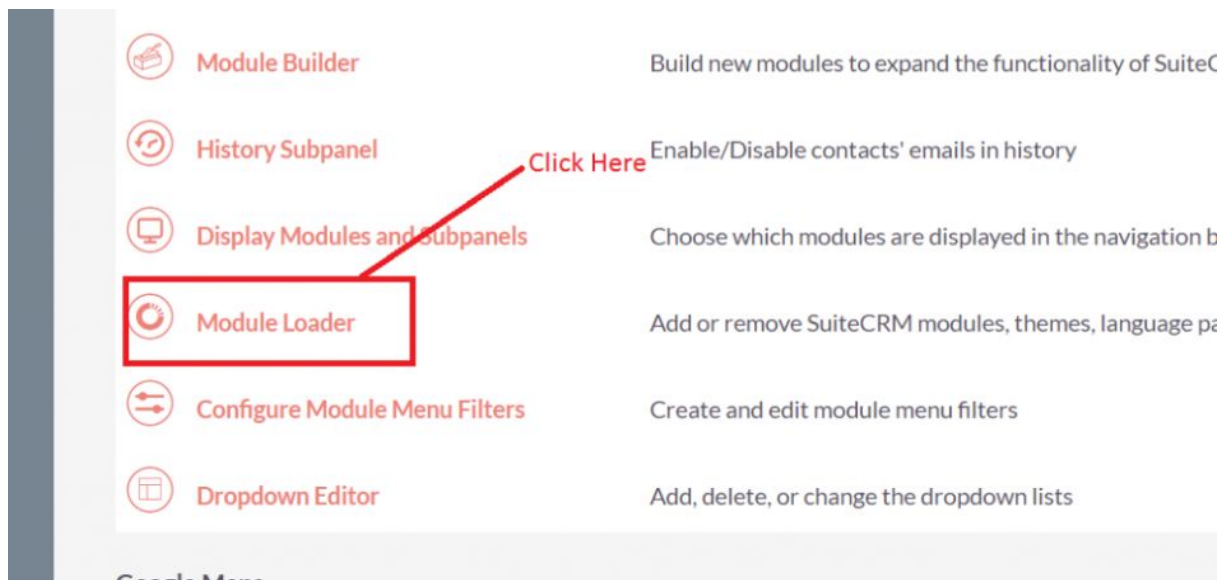

3. Click on "**Choose File**" button and select the GlobalHideManager.zip

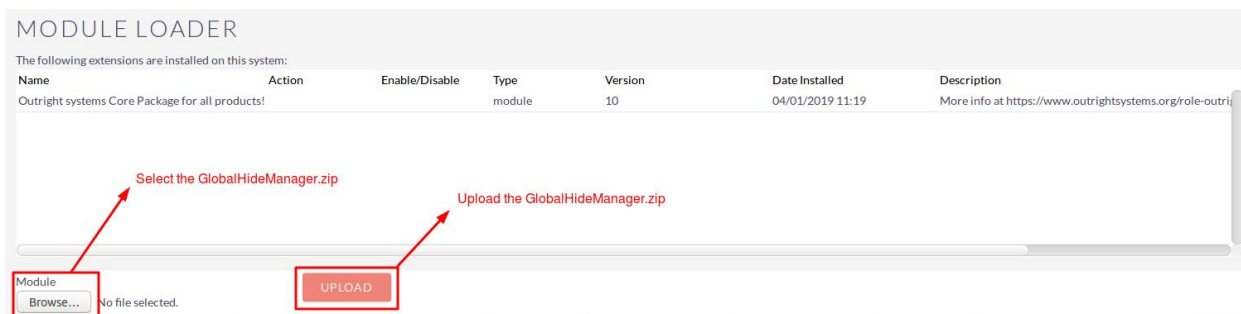

4. Click on "**Upload**" to upload the file in CRM and then click on the Install button.

MODULE LOADER

The following extensions are installed on this system:

Name	Action	Enable/Disable	Type	Version	Date Installed	Description
Outright systems Core Package for all products!			module	11	05/30/2019 11:39	More info at https://www.outrightsystems.org/role-outright-util

Click Here to install the package

Module

Choose file No file chosen

UPLOAD

Name	Install	Delete	Type	Version	Date Published	Uninstallable	Description
Outright_Global_Hide_Manager	INSTALL	DELETE PACKAGE	Module	3.0		Yes	Installs Outright Global Hide Manager

5. Again go to the Administration page and click on repair.

ADMINISTRATION SALES MARKETING SUPPORT ACTIVITIES COLLABORATION ALL

Backups Languages Repair Global Search Diagnostic Tool Connectors

Click Here

Backup SuiteCRM files

Which languages are available for users

Check and repair SuiteCRM

Configure the global search options for the system

Capture system configuration for diagnostics and analysis

Manage connector settings

6. Click on "**Quick Repair and Rebuild**" and click on execute button.

NOTE: any changes you make to the script in the textbox will be reflected in the exported or executed code.

```
/* Table : outr_global_hide_manager */  
/* MISSING TABLE: outr_global_hide_manager */  
CREATE TABLE outr_global_hide_manager (id char(36) NOT NULL ,name varchar(255) NULL ,date_entered datetime  
NULL ,date_modified datetime NULL ,modified_user_id char(36) NULL ,created_by char(36) NULL ,description text  
NULL ,deleted bool DEFAULT '0' NULL ,assigned_user_id char(36) NULL ,status varchar(255) NULL ,element_id  
varchar(100) NULL ,element_class varchar(100) NULL ,mod_name varchar(255) NULL , PRIMARY KEY (id))  
CHARACTER SET utf8 COLLATE utf8_general_ci;
```

Click here to execute the above queries

EXECUTE

EXPORT

NOTE: after installing each plugin, It is mandatory to repair and execute.